

7.50 inches [19.05 cm]

inches

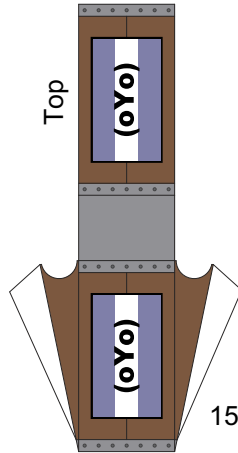
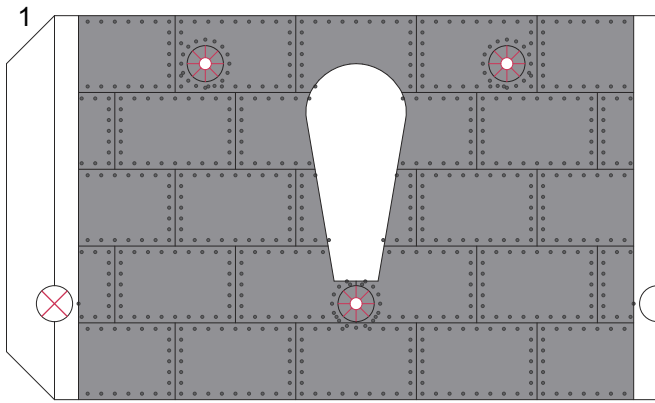
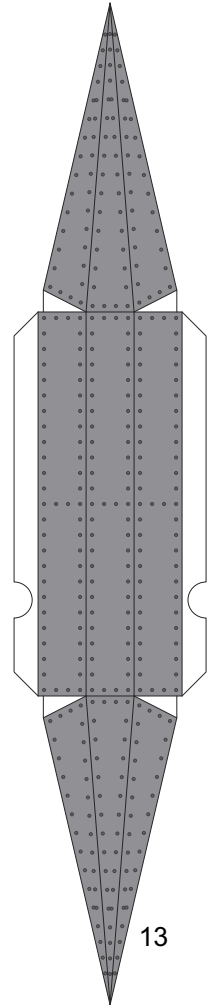
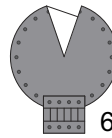
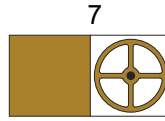
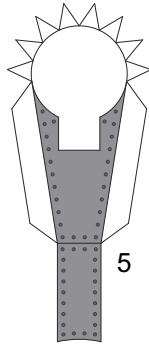
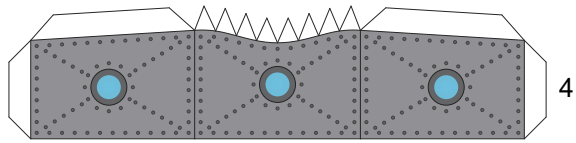
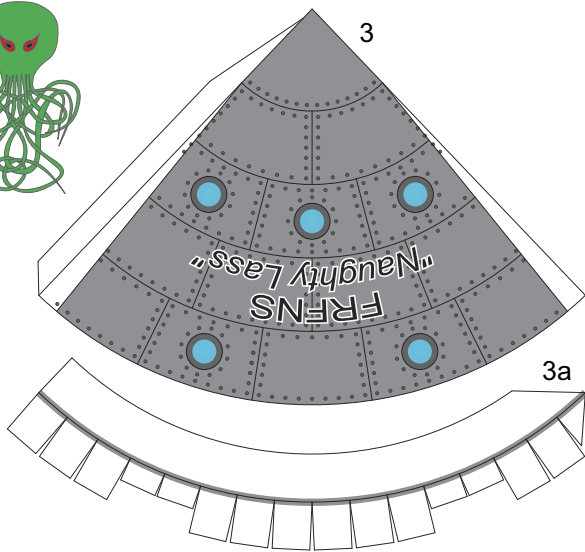
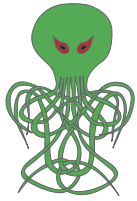

16

2

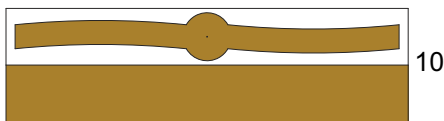
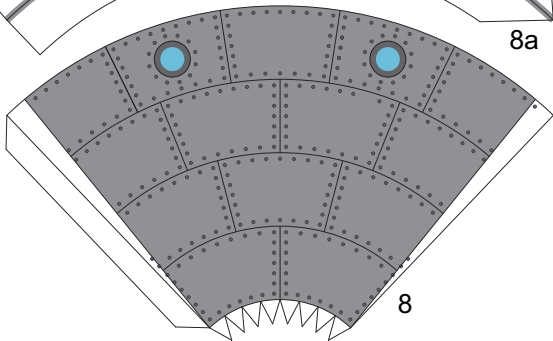
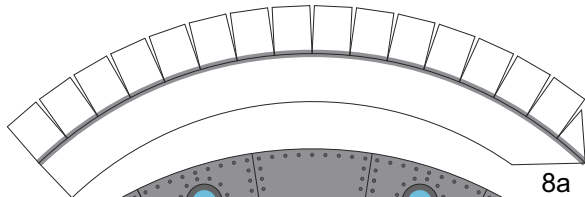

9a

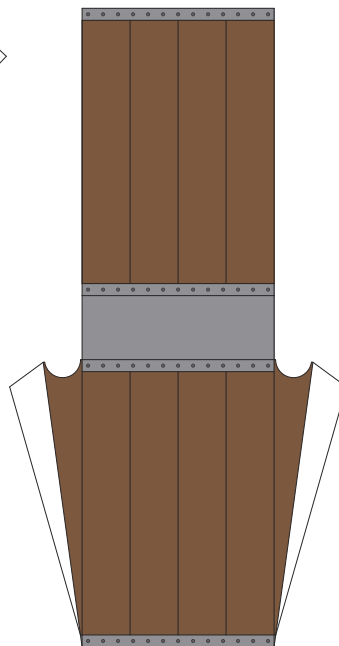
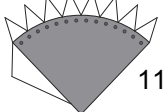

14

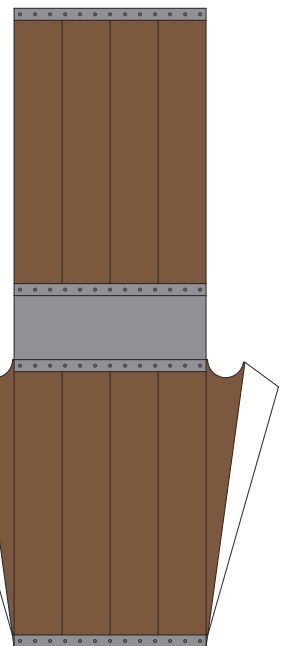

10.00 inches [25.40 cm]

cm

cm

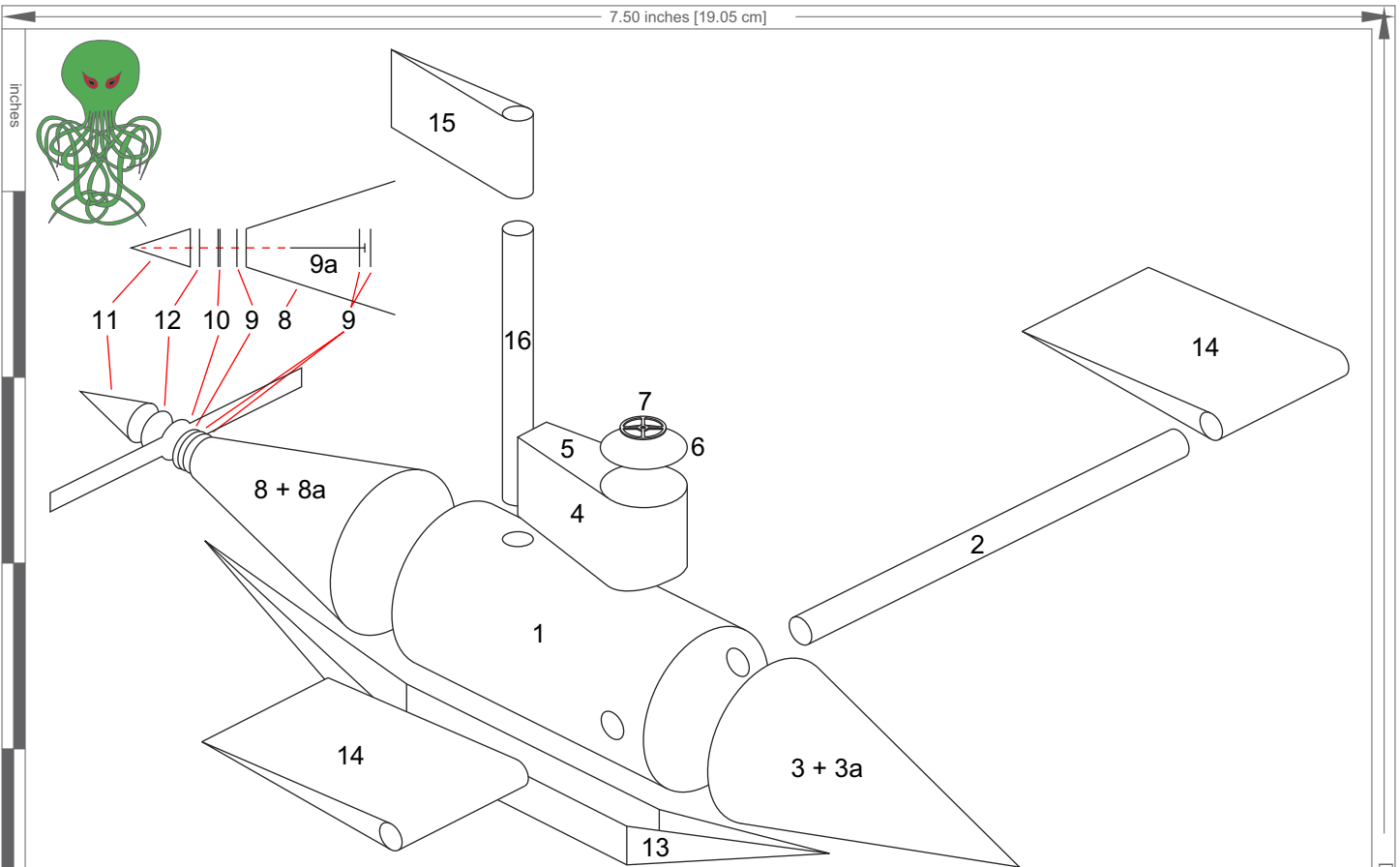

NOTE: Parts 2 and 16 are wooden dowels, bamboo skewers, or lollipop sticks, approximately 3/16 (0.1875) inch in diameter (between 4 and 5 mm). Cut to the lengths indicated on the parts page. Part 9a is a metal sewing pin, cut to the length indicated on the parts page.

Part 1: Cut on the red lines in the three circular areas, and gently fold the resulting tabs to the inside of the part. Remove the circle indicated with a red X. Roll part 1 into a cylinder. The seam is on the bottom.

Part 2: Push through one of the tabbed holes in part 1, then guide through the opposite hole while keeping all the tabs to the inside of part 1. Do not glue.

Part 3: Glue part 3a to the back of part 3, then form part 3 into a cone. Set this assembly aside for now.

Parts 4, 5, 6, 7: Assemble parts 4 and 5 into the sail as shown, then glue to the top of part 1 where indicated. Glue part 6 to part 5 where indicated. Glue part 7 to the tip of part 6.

Parts 8 - 12: Pierce parts 9, 10, and 12 with a needle or sewing pin. Part 10 should move freely on part 9a, but part 12 and the three parts 9 should be snug. Put part 9a through one of the uncolored parts 9 and glue the head of the pin to the part. Glue the other uncolored part 9 down over the pin head firmly. Let this assembly dry.

Glue part 8a to the back of part 8, then form part 8 into a shroud. Glue the colored part 9 to the tabs at the end of part 8. Form part 11 into a cone. Glue part 12 to the tabs of part 11. Put the pin (part 9a) through the colored part 9 from the inside of part 8 and glue firmly into place. When the glue has dried, fit part 10 over part 9a, then fit part 12 over part 9a to cap the pin. Part 10 should turn freely on part 9a.

Fit the tabs of part 8a into the end of part 1, aligning the seam of part 8 with the seam of part 1, and glue into place.

Part 3: Fit the tabs of part 3a into the end of part 1, aligning the seam of part 3 with the seam of part 1, and glue into place.

Part 13: Glue part 13 into the trough shape shown in the diagram. Carefully glue part 13 to parts 1, 3, and 8 where indicated, making sure that the hole in the bottom of part 1 is unobstructed.

Parts 14, 15, 16: Form parts 14 and 15 into the paddle shapes shown. Fit a part 14 over each end of part 2, with a bit of part 2 extending out of the parts 14, make sure both parts 14 are pointed the same way, and glue just at the ends. Fit part 15 over the end of part 16 in the same way, and glue just at the end. Push part 16 down through the hole in the top of part 1, and on through the hole in the bottom of part 1. Parts 14 should move up and down together with some resistance. Part 15 should move from side to side with some resistance.